

Spaces



IMAX

The BFI IMAX is a breath of fresh air – situated in the heart of London with access to excellent local, national and European transportation networks. Our prime location ensures your delegates and guests are relaxed when they arrive, ready to enjoy themselves.



“An extraordinary phenomenon... a new public building that adds to the urban quality of the capital.”
Architectural Review

“We have received excellent feedback about the night and your staff, and are delighted that we had the opportunity to hold the event at the IMAX. Next time you will be our first choice!”

Fairbridge Charity

“A wonderful venue which worked perfectly for us. I will certainly look for opportunities of using the IMAX again.”

HSBC

“Please extend our gratitude to your team who worked really hard to make the day a success. Looking forward to working with you in the future.”

BBC

“The venue itself is absolutely amazing, but coupled with your thoughtfulness, flexibility and constant care, it really played a major part in the overall success of the event.”

Kick Events

“The feedback from Film Four has been brilliant and they have asked us to express their thanks to you as well.”

Bacchus PR

“When organising an event on such a large scale it is greatly appreciated to have such efficient service. Thank you.”

Barclay Stratton



THE PERFECT MEETING PLACE

Award-winning architect Bryan Avery designed the cinema. It's worth a special journey itself. Built on springs the building is immune to the vibration from a network of busy tunnels directly beneath it and the walls are 750mm thick to stop traffic noise. An exterior image wall can also be used as an advertising billboard!

We are perfectly suited for presentations, premieres, console gaming, awards ceremonies and launches; as well as informal meetings and small exhibitions.



THE BIGGER PICTURE

The auditorium boasts 14 rows of steeply raked comfortable seats, enabling all participants a full, unobstructed view of the speaker and screen. Our extraordinary 20m by 26m screen (the largest in the UK) can be used as a virtual stage with dramatic lighting effects. This can stand alone or work to compliment a temporary stage that can be erected.

We have 480 seats, and our events tend to cater for audiences between 100 and 450. We can look after 320 guests in the 1st floor foyer, and a further 180 on the ground floor for refreshments, networking and standing receptions.



FLEXIBLE & ACCESSIBLE

There is a full range of facilities integrated into the design of the BFI IMAX and it has accessibility built in: lifts; an induction loop; wheelchair spaces; fully accessible toilets; facilities for recharging power chairs and guide dogs are welcome.

We are a very flexible venue, and anything we don't have on-site can be brought in; from live satellite feeds to Formula 1 racing cars – as well as anything in between!

All of us at the BFI IMAX are wholly dedicated to the success of your event, from the excellence of the cuisine to the efficient and professional service of the management team.



FACILITIES IN BRIEF

- Available for daytime and evening functions
- Stadium seating for up to 450
- A silver screen reaching 20m high and 26m across
- IMAX 2D and 3D systems
- 70mm and 35mm film projectors
- 1 minute from Waterloo International Station

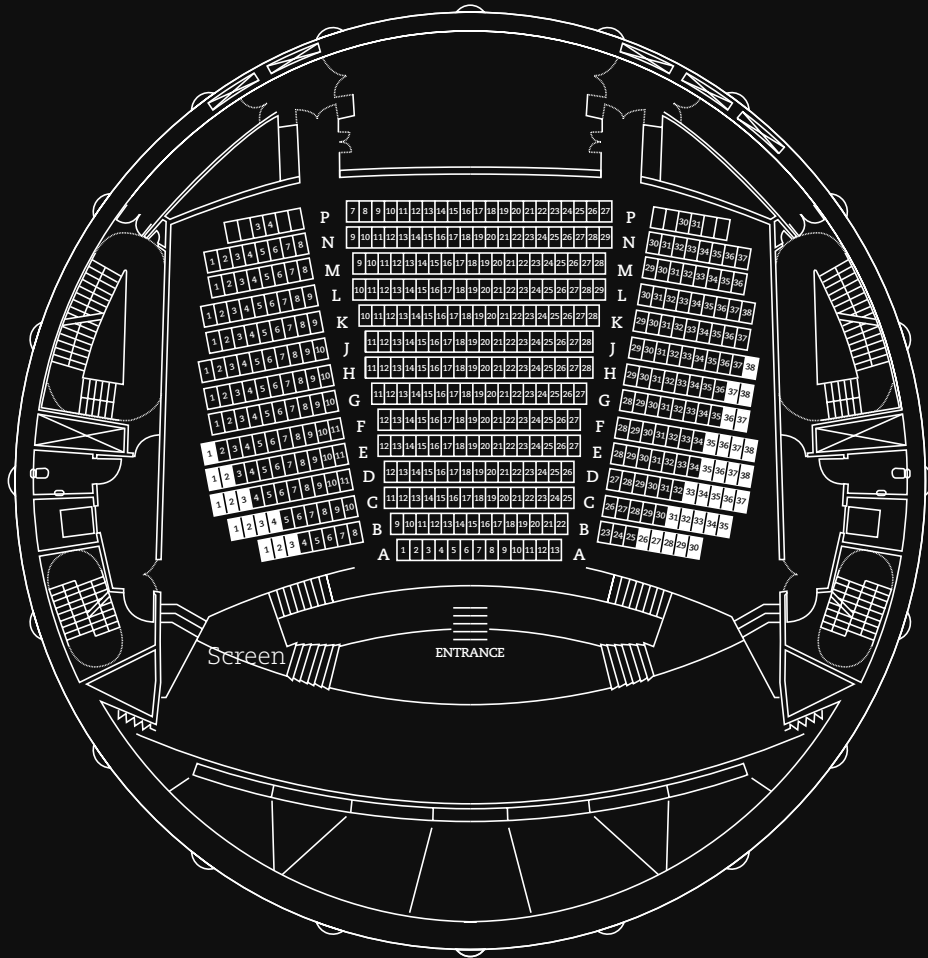

AUDITORIUM

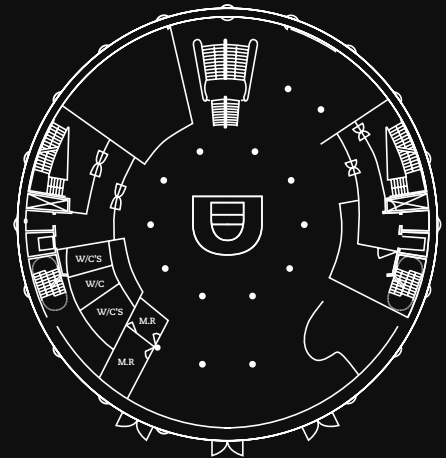

GROUND FLOOR

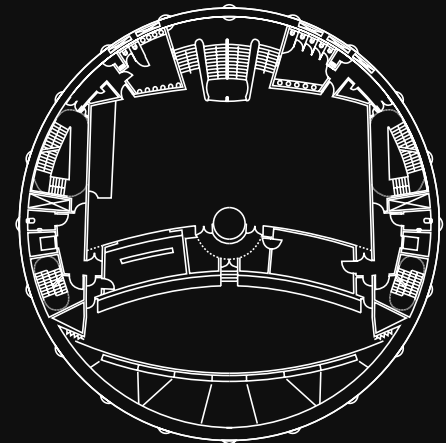

FIRST FLOOR

Catering

The 1st floor foyer is spacious enough to look after 320 guests and a further 180 can be accommodated on the ground floor, for refreshments and standing receptions. There is also a fully licensed bar measuring approximately 3 1/2 metres on the 1st floor.

The BFI IMAX use in-house caterers who look after all your event needs, be they overnight sustenance for the production team or party food for your delegates. Tastings and portion sizes can be arranged and agreed upon in advance.

Alcohol may be taken into the auditorium in plastic glasses.



FIRST FLOOR BAR



FILM CAFÉ

To view the site and discover how the BFI IMAX can turn your event into a success, please call the sales team on 020 7960 3130.

LOCATION

Situated on the South Bank, BFI IMAX is perfectly located for all public transport including Waterloo Mainline and Underground Station.

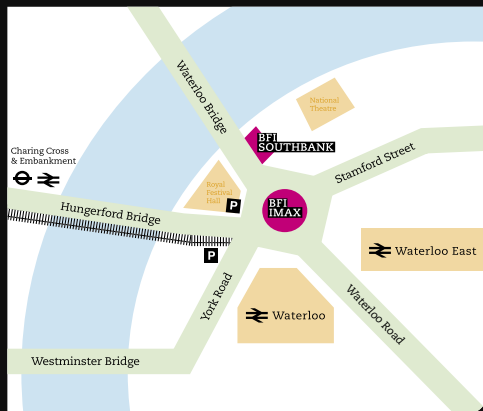

BFI IMAX
1 Charlie Chaplin Walk
South Bank
London SE1 8XR
www.bfi.org.uk/imax

To arrange a viewing of this exciting and flexible destination venue please contact:

Lucy Jennings
Events Manager,
BFI IMAX
Charlie Chaplin Walk,
Waterloo, London SE1 8XR

lucy.jennings@bfi.org.uk
020 7960 3130

HOW TO GET HERE

By Bus

Routes 1, 4*, 26, 59, 68, 76, 77, 139*, 168, 171, 172, 176, 188, 211, 243*, 341, 381, 507*, 521*, RV1

By Tube

Waterloo, Embankment and Charing Cross (cross Hungerford Bridge to Southbank)

By Train

Waterloo/Charing Cross

Car Parking

Euro car park sites available under the National Theatre (off Upper Ground), under the Hayward Gallery and in front of the Shell Centre.

BFI Southbank and BFI IMAX are within the congestion charge zone.

DISABLED ACCESS

All screens and facilities at BFI Southbank and BFI IMAX are fully accessible to wheelchair users.

All screens have induction loop facilities. BFI Southbank minicom number is 020 7620 2025

We welcome Assistance Dogs at BFI Southbank and BFI IMAX. Please help us to accommodate you better by booking in advance so that we can allocate the most appropriate seating.

There's more to discover about film and television through the BFI. Our world-renowned archive, cinemas, festivals, films, publications and learning resources are here to inspire you.